

Remove the preload knob.
取下预紧旋钮。

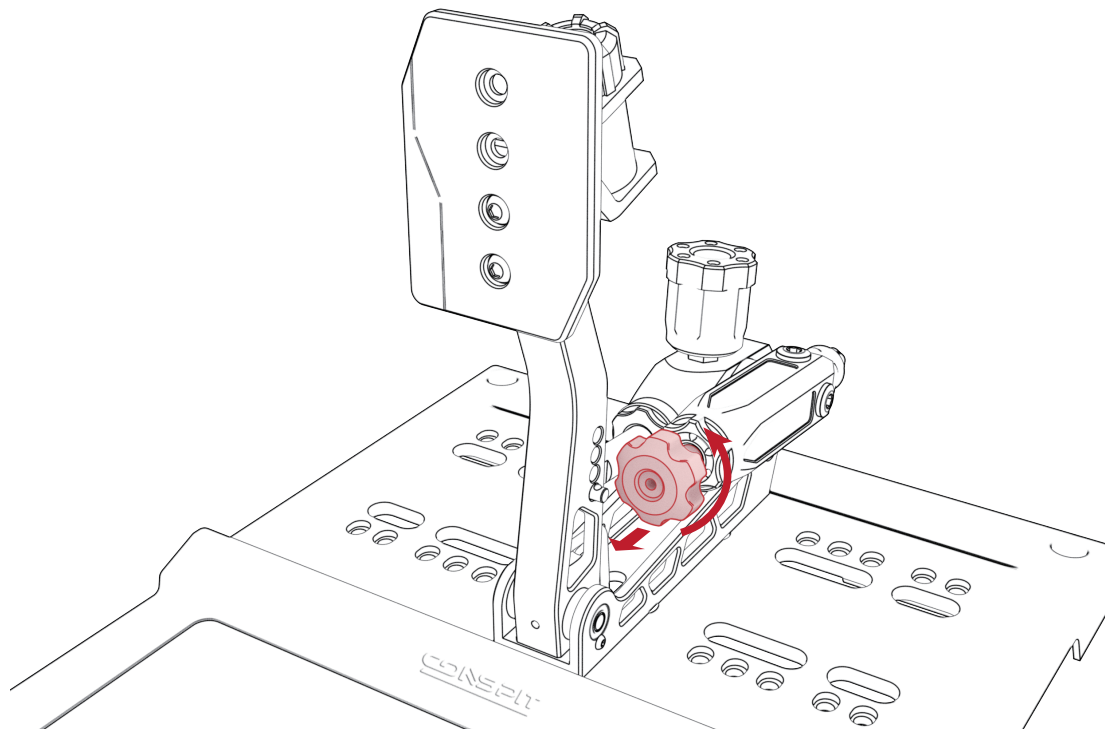

Use the tool to remove the elastomer cylinder nut.
使用工具取下胶缸螺母。

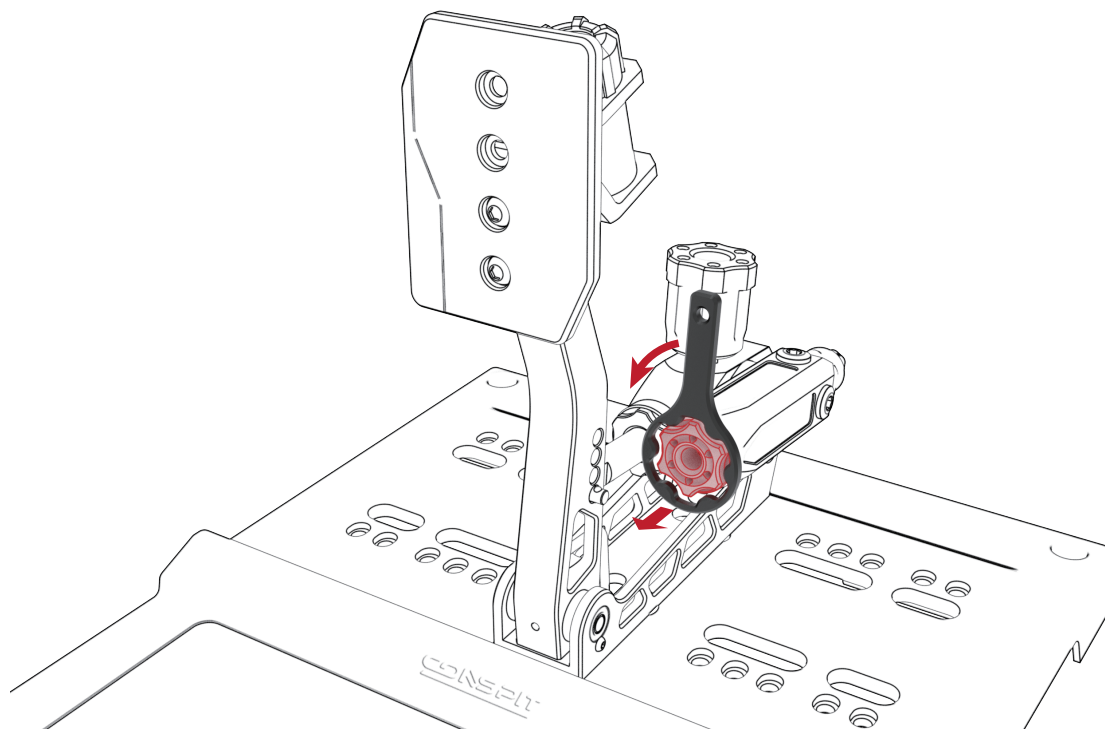

Gently press the pedal to push out the gaskets and elastomers. **Do not apply excessive force.**
轻压踏板以推出垫圈和胶块。**请勿过度用力。**

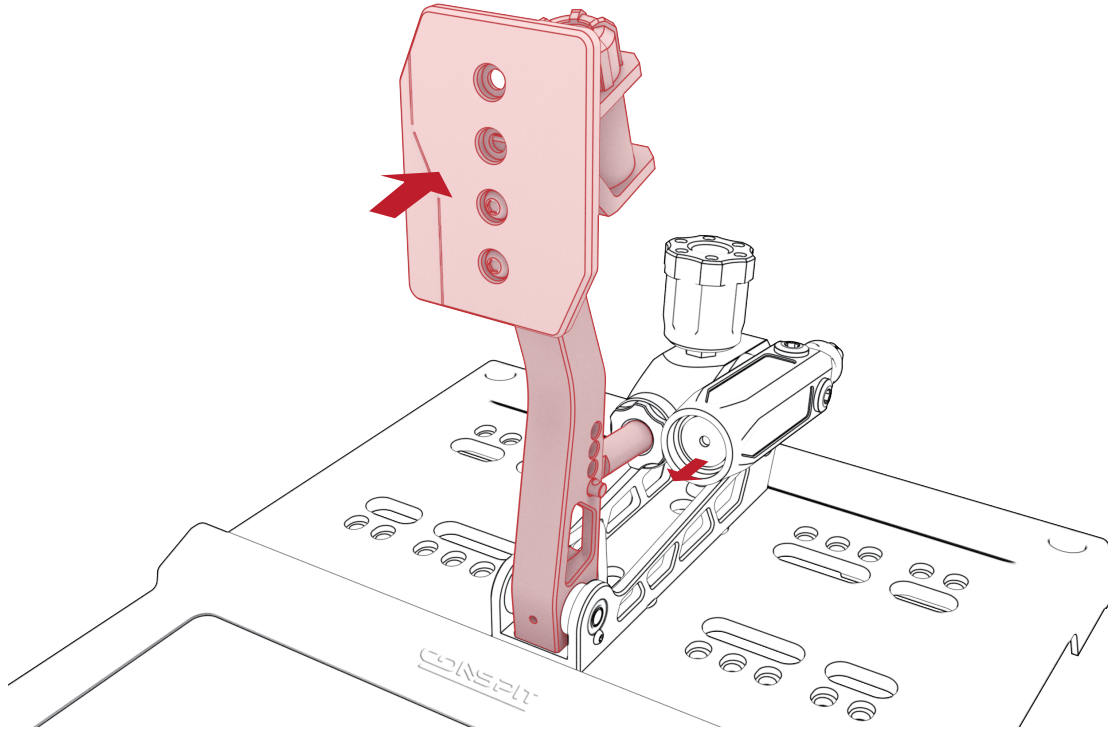

Remove the gaskets and used elastomers.
取出垫圈胶块。

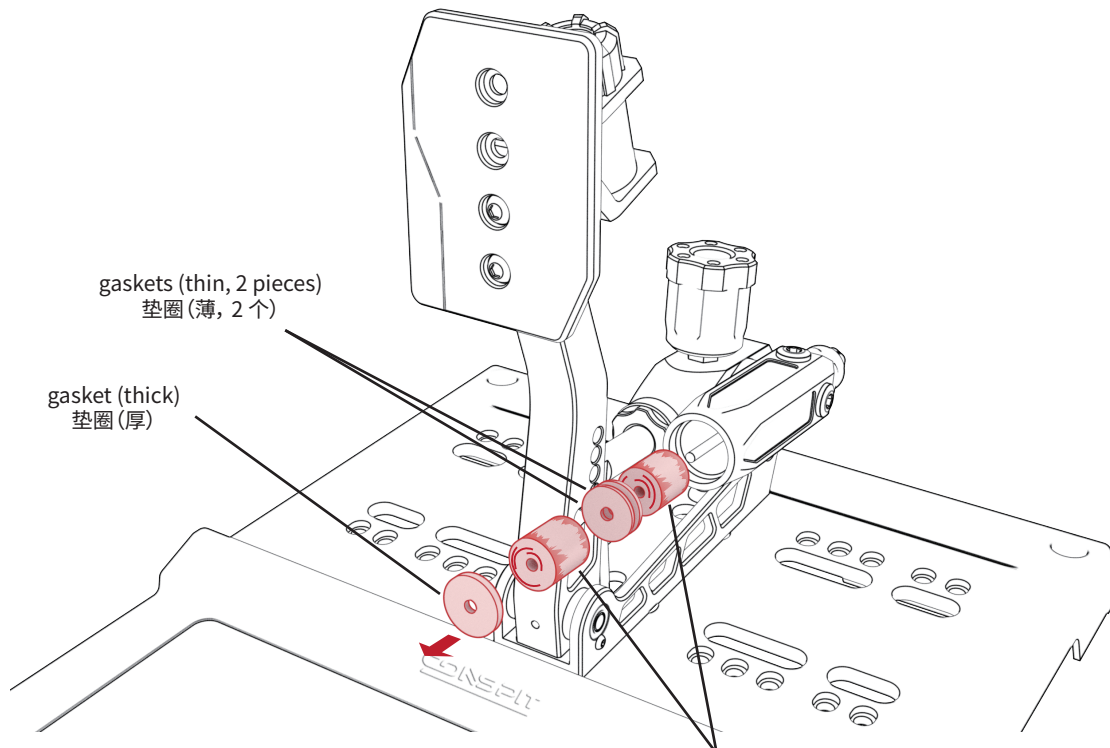

If it is difficult to remove, you can use a thinner object (such as a thin hex wrench) to pick them out.
若难以取出,可使用较细的物品(如较细的内六角扳手)挑出。

used elastomers (2 pieces)
旧的胶块 (2个)

Apply lubricating grease evenly on the cylinder shaft.
在缸轴上均匀涂抹润滑脂。

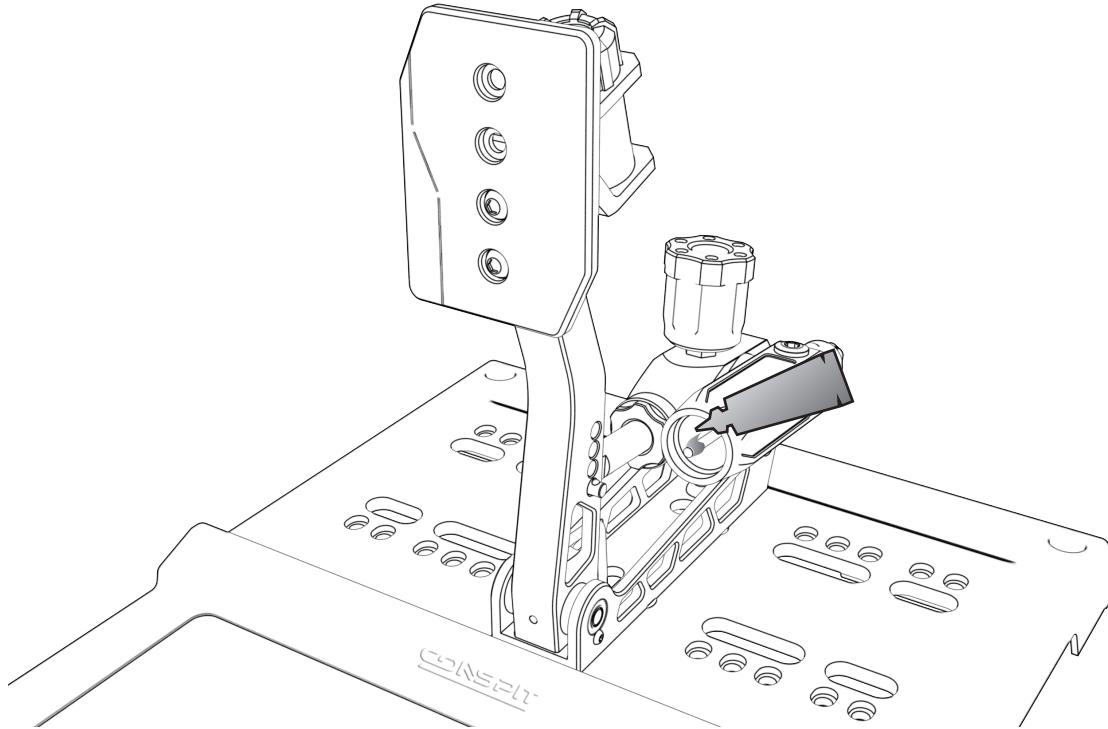

Replace the new elastomers and put the gaskets and elastomers back in their original order.

Note: Please replace both elastomers at the same time!

更换新的胶块, 并将垫圈和胶块按原顺序放入。**注意: 请同时更换两个胶块!**

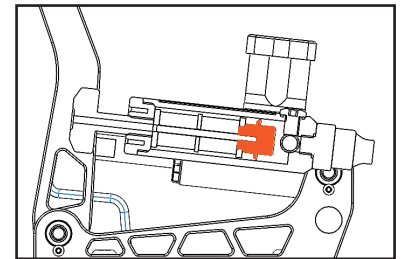
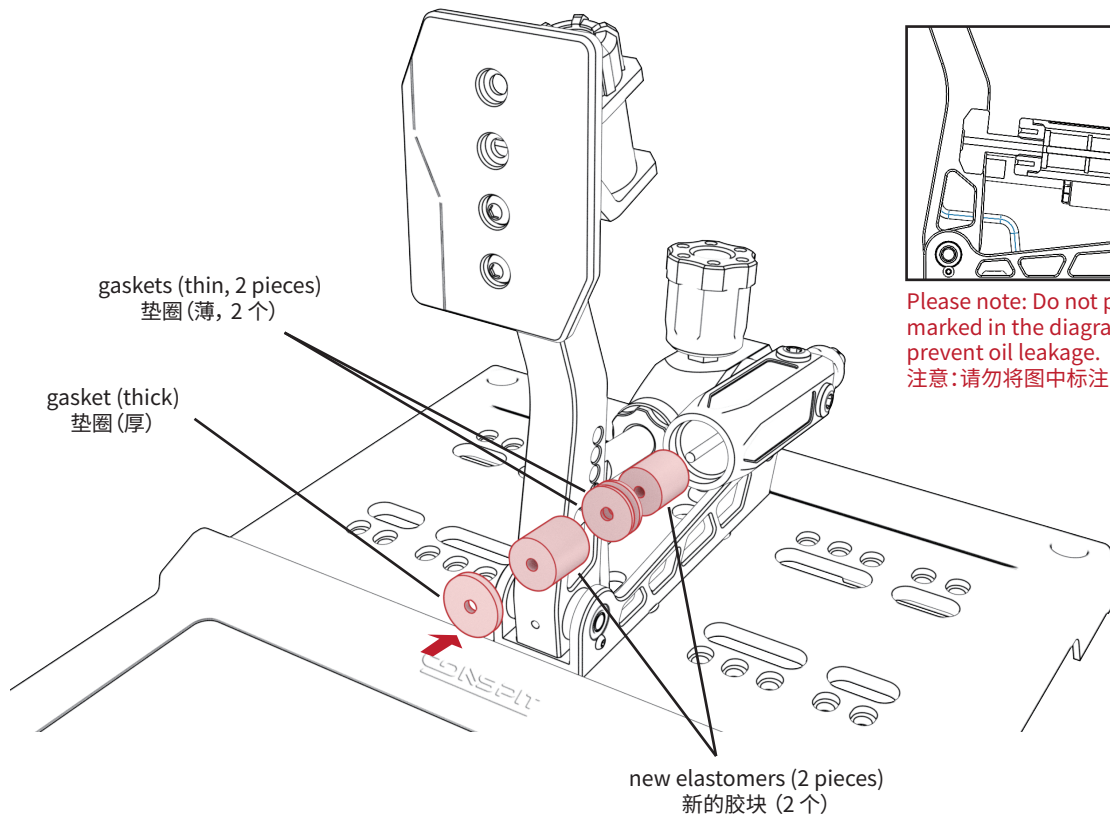

Please note: Do not pull the piston as marked in the diagram out of its place to prevent oil leakage.
注意: 请勿将图中标注的活塞带出, 避免漏油。

Push the gaskets and elastomers into the cylinder.
将垫圈和胶块推入胶缸。

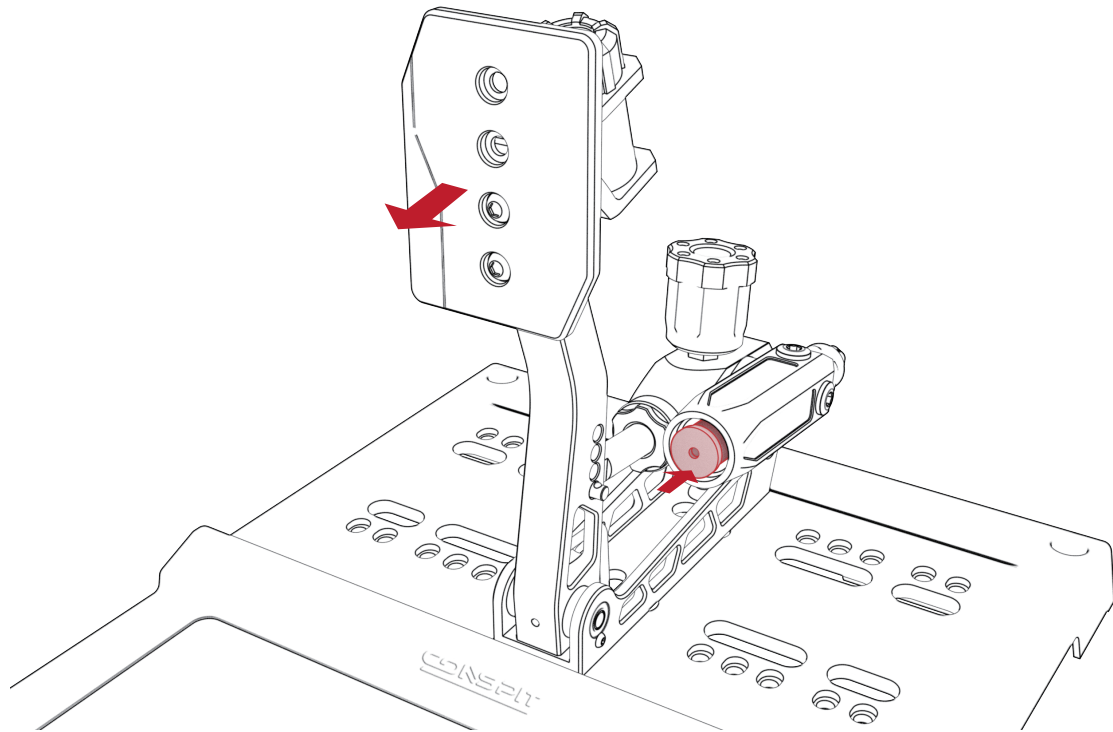

Install the elastomer cylinder nut using tools.
使用工具装回胶缸螺母。

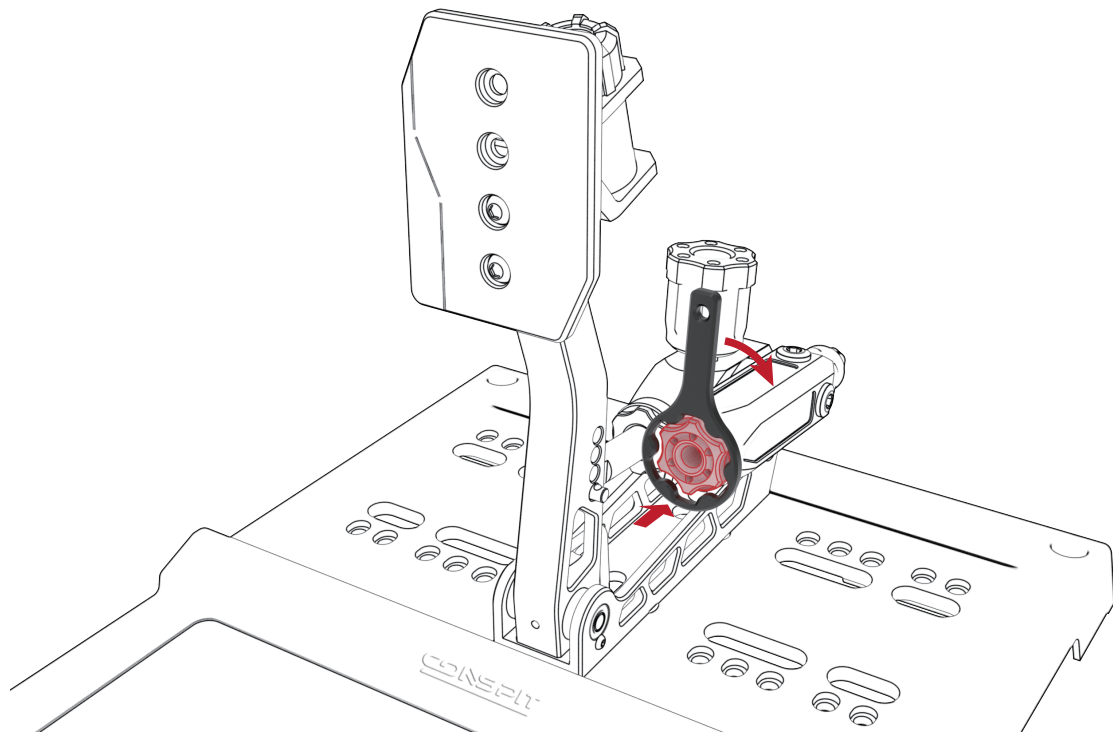

Install the preload knob.
装回预紧旋钮。

